

MS SAINTE ODILE



Built : 1992 (refurbished in 2006)
Length : 90 m long
Width : 10 m wide
Cabins : 64 cabins
Passengers : 131passengers
Equipments : all cabins are equipped with shower and toilet, hairdryer, satellite TV, radio, safe.
 Central heating, 220V electricity, air-conditioning, radar, radiophone.
Facilities : lounge-bar with a dance floor - bar - dining room - large sundeck with deckchairs - gift shop.



MS Sainte Odile sails on the Rhine and tributaries.



2 deck ship

CABINS

- Upper deck 20 cabins (9 double, 11 twins)
- Main deck 44 cabins (4 triple, 1 single, 9 double, 30 twins)

Cabin equipped for disabled : **NO**

S = single cabin
 G = cabin with a double bed
 T = triple cabin

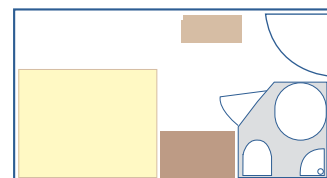

Cabin with a double bed

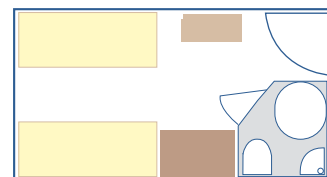

Cabin with 2 single beds

